



GE34H SQUARE (AVAILABLE IN BLACK)

CODE	LENGTH	WEIGHT
GE34H050	50CM	7.30KG
GE34H100	100CM	9.60KG
GE34H150	150CM	12.00KG
GE34H200	200CM	14.00KG
GE34H250	250CM	16.40KG
GE34H300	300CM	18.70KG

TECHNICAL DATA

Pipe Diameter	50mm
Wall Thickness	2mm
Braces	20x2mm
Material	EN AW 6082 T6
Connector	Included

SECTION

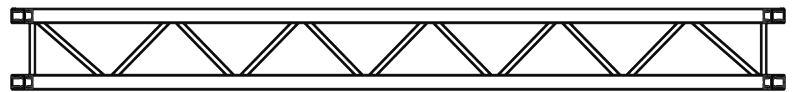
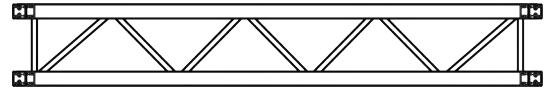
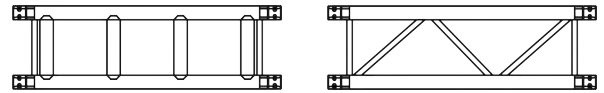
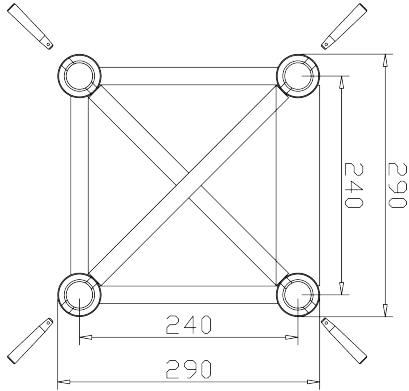

LOAD TABLE

Span	UDL	Deflection	CPL	Deflection	Point load in third-point	Deflection	Point load in quarter-point	Deflection	Point load in fifth-point	Deflection
长度	承重量/m	弯曲度	中间点承重量	弯曲度	三点承重量	弯曲度	四点承重量	弯曲度	五点承重量	弯曲度
m	kg m	cm	kg	cm	kg	cm	kg	cm	kg	cm
4	502.5	1.36	629	0.8	552.5	1.3	444.3	1.28	396.6	1.29
5	320.2	2.3	569.8	1.01	492.6	2.18	387.5	2.09	332.2	2.09
6	221	3.36	520.8	1.64	444.3	3	331.7	3.06	275.3	3.09
7	160	4.61	479.5	2.43	404.7	4.2	282.4	4.22	234.4	4.29
8	122	6.06	444.3	3.39	367.9	5.8	245.3	5.56	203.6	5.68
9	95	7.71	413.9	4.51	324.2	7	216.1	7.1	179.4	7.28
10	76	9.55	385.2	5.8	288.9	8.3	192.6	8.82	159.9	9.07
11	62	11.6	346.4	7.26	259.8	10.76	173.2	10.75	143.7	11.08
12	51	13.85	313.6	8.89	235.3	12.97	156.8	12.87	130.2	13.29
13	43	16.29	285.7	10.71	214.3	15.39	142.8	15.19	118.6	15.7
14	36	18.95	241.4	12.71	196.1	18.03	130.7	17.71	108.5	18.33
15	31	21.81	240.1	14.91	180.1	20.89	120.1	20.44	99.6	21.18
16	27	24.88	221.2	17.3	165.9	23.99	110.6	23.38	91.8	24.24
17	24	28.16	204.4	19.9	153.3	27.32	102.2	26.53	84.8	27.52
18	21	31.65	189.1	22.71	141.8	30.89	94.6	29.9	78.6	31.03



GE34H SQUARE

GE34H is a 4-point truss system. This provides optimum volume and load capacity for its construction size and a tube diameter of 50mm. This system is connected via a special conical connector system, which is joined together to a complete form fit by means of a copper hammer, creating optimal traction.

GE34H finds application in trade fairs and shops, as well as in the event industry in general. It is also characterised by a minimum transport volume and the special lightweight design.

The conical connectors are of course included in the scope of delivery - special designs and powder coatings can be carried out at short notice.

GE34H系列桁架为四方架系统，其材料均为通过 EN 认证的 6082 T6 铝合金型材，主管直径为 50mm，管壁厚度 2mm，副管直径 20mm，管壁厚度 2mm。此桁架为插销连接方式，属于多用途桁架的一种，可完美解决中小型方案的载重需求，此桁架既适用于展会，酒店，商场等场所的装饰，也能用于灯具挂载。桁架的设计由德国工程师研发，生产遵循德国工业标准并荣获德国“RWTUV”认证，是一款极具性价比的优势产品。桁架可依照需求进行特殊造型定制，以及表面可做烤漆处理

AVAILABLE IN

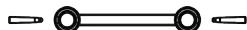

LADDER

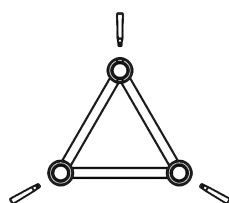

TRIANGLE

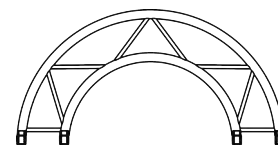

CIRCULAR



GE34H CIRCLE (AVAILABLE IN BALCK)



CODE	DIAMETER	PART/DEG	WEIGHT
GE34HR10-180	2.0M	180°	17.00KG
GE34HR15-90	3.0M	90°	13.00KG
GE34HR20-90	4.0M	90°	16.40KG
GE34HR25-45	5.0M	45°	11.20KG
GE34HR30-60	6.0M	60°	16.20KG
GE34HR35-45	7.0M	45°	15.00KG
GE34HR40-45	8.0M	45°	16.50KG
GE34HR45-45	9.0M	45°	19.00KG

45° 2 WAYS CORNER

CODE GE34HC19

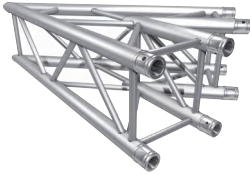

| 29 / 100 - 100

8.85KG

60° 2 WAYS CORNER

CODE GE34HC20

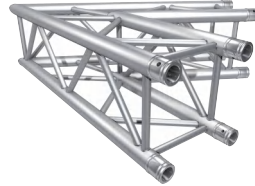

| 29 / 100 - 100

9.97KG

90° 2 WAYS CORNER

CODE GE34HC21



| 29 / 50 - 50

6.27KG

120° 2 WAYS CORNER

CODE GE34HC22



| 29 / 50 - 50

6.48KG

135° 2 WAYS CORNER

CODE GE34HC23



| 29 / 50 - 50

6.63KG

90° 3 WAYS CORNER

CODE GE34HC30



| 50 / 50 - 50

8.98KG

3 WAYS T CORNER

CODE GE34HT35



| 29 / 50 - 50

7.82KG

90° 4 WAYS CORNER

CODE GE34HT40

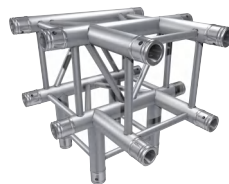

| 50 / 50 - 50

9.55KG

4 WAYS CROSS CORNER

CODE GE34HT41

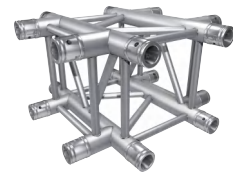

| 50 / 50 - 29

8.85KG

5 WAYS CORNER

CODE GE34HC55



| 50 / 50 - 50

11.48KG

BOX CORNER

CODE GE34HBOX



| 29 / 29 - 29

5.69KG

BASE PLATE

CODE GE34HBASE

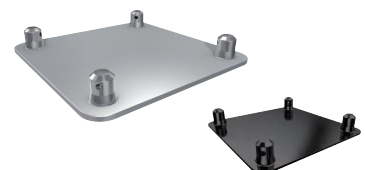

| 5 / 30 - 30

1.5KG

<p>FLEXIBLE CORNER</p>	<p>SPINDLE</p>	<p>BOX SPACER</p>
<p>CODE GE34HFC0-180</p>  <p> 29 / 8 - 34</p> <p>9.9KG</p>	<p>CODE GE34HSD</p>  <p> 35 / 29 - 29</p> <p>2.5KG</p>	<p>CODE GE34HBOXS105F CODE GE34HBOXS210F</p> 
<p>BOX HALF CONNECTOR</p>	<p>BASE HALF CONNECTOR</p>	<p>CONICAL CONNECTOR</p>
<p>CODE GE34HBOX-C</p> 	<p>CODE 5003(ALUMINUM) CODE 5010(STEEL)</p> 	<p>CODE 5002</p> 
<p>CONICAL HINGE</p>	<p>PIN</p>	<p>R CLIP</p>
<p>CODE 5029SR CODE 5029SL</p> 	<p>CODE 5004PIN</p> 	<p>CODE 5004CLIP</p> 
<p>PIN & BOLT</p>	<p>SPACER MALE</p>	<p>SPACER FEMALE</p>
<p>CODE 5005</p> 	<p>CODE 5019M105 CODE 5020M170 CODE 5021M210</p> 	<p>CODE 5019F105 CODE 5020F170 CODE 5021F210</p> 