

## GE34 SQUARE (AVAILABLE IN BLACK)

CODE	LENGTH	WEIGHT
GE34050	50CM	4.90KG
GE34100	100CM	7.50KG
GE34150	150CM	9.70KG
GE34200	200CM	12.00KG
GE34250	250CM	14.00KG
GE34300	300CM	16.00KG

## SECTION

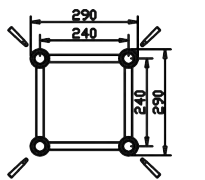

## TECHNICAL DATA

Pipe Diameter	50mm
Wall Thickness	2mm
Braces	20x2mm
Material	EN AW 6082 T6
Connectors	Included

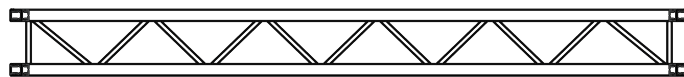
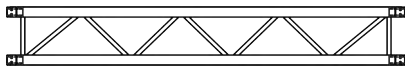
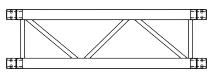

## GE34 CIRCLE (AVAILABLE IN BLACK)

CODE	DIAMETER	PART/DEG	WEIGHT
GE34R10-180	2.0M	180°	17.00KG
GE34R15-90	3.0M	90°	13.00KG
GE34R20-90	4.0M	90°	16.40KG
GE34R25-45	5.0M	45°	11.20KG
GE34R30-60	6.0M	60°	16.20KG
GE34R35-45	7.0M	45°	15.00KG
GE34R40-45	8.0M	45°	16.50KG
GE34R45-45	9.0M	45°	19.00KG

## LOAD TABLE

Span	UDL	Deflection	CPL	Deflection	Point load in third-point	Deflection	Point load in quarter-point	Deflection	Point load in fifth-point	Deflection
长度	承重量/m	弯曲度	中间点承重量	弯曲度	三点承重量	弯曲度	四点承重量	弯曲度	五点承重量	弯曲度
m	kg   m	cm	kg	cm	kg	cm	kg	cm	kg	cm
4	501	1.36	922	1.01	627	1.16	496	1.28	393	1.29
5	344	2.3	763	1.64	528	1.93	411	2.09	324	2.09
6	241	3.36	649	2.43	455	2.89	346	3.06	274	3.09
7	177	4.61	562	3.39	398	4.06	297	4.22	237	4.29
8	135	6.06	494	4.51	353	5.42	260	5.56	208	5.68
9	106	7.71	440	5.8	316	7	230	7.1	185	7.28
10	85	9.55	395	7.26	285	8.77	205	8.82	166	9.07
11	69	11.6	357	8.89	258	10.76	185	10.75	150	11.08
12	58	13.85	324	10.71	236	12.97	168	12.87	136	13.29
13	48	16.29	296	12.71	216	15.39	153	15.19	125	15.7
14	41	18.95	271	14.91	199	18.03	140	17.71	114	18.33
15	35	21.81	249	17.3	183	20.89	128	20.44	105	21.18
16	30	24.88	229	19.9	169	23.99	118	23.38	97	24.24
17	26	28.16	211	22.71	157	27.32	109	26.53	89	27.52
18	23	31.65	195	25.74	146	30.89	100	29.9	82	31.03

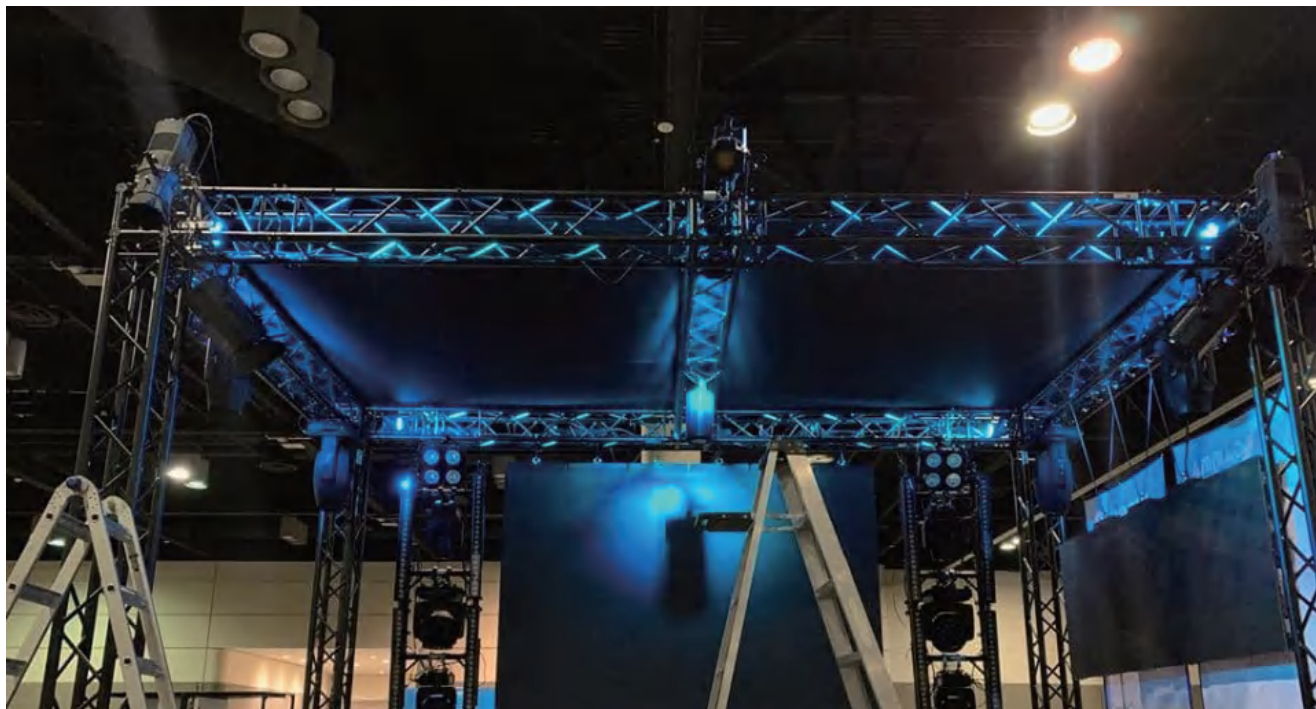

## GE34 SQUARE

GE34 is a 4-point truss system. This provides optimum volume and load capacity for its construction size and a tube diameter of 50mm. This system is connected via a special conical connector system, which is joined together to a complete form fit by means of a copper hammer, creating optimal traction.

GE34 finds application in trade fairs and shops, as well as in the event industry in general. It is also characterised by a minimum transport volume and the special lightweight design.

The conical connectors are of course included in the scope of delivery - special designs and powder coatings can be carried out at short notice.

GE34 系列桁架为四方架系统，其材料均为通过 EN 认证的 6082 T6 铝合金型材，主管直径为 50mm，管壁厚度 2mm，副管直径 20mm，管壁厚度 2mm。此桁架为插销连接方式，属于多用途桁架的一种，可完美解决中小型方案的载重需求，此桁架既适用于展会，酒店，商场等场所的装饰，也能用于灯具挂载。桁架的设计由德国工程师研发，生产遵循德国工业标准并荣获德国“RWTUV”认证，是一款极具性价比的优势产品。桁架可依照需求进行特殊造型定制，以及表面可做烤漆处理。

## AVAILABLE IN

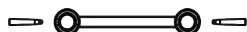

LADDER

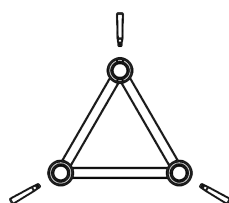

TRIANGLE

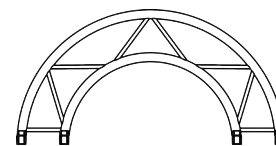

CIRCULAR



## GE34 CIRCLE (AVAILABLE IN BALCK)



CODE	DIAMETER	PART/DEG	WEIGHT
GE34R10-180	2.0M	180°	17.00KG
GE34R15-90	3.0M	90°	13.00KG
GE34R20-90	4.0M	90°	16.40KG
GE34R25-45	5.0M	45°	11.20KG
GE34R30-60	6.0M	60°	16.20KG
GE34R35-45	7.0M	45°	15.00KG
GE34R40-45	8.0M	45°	16.50KG
GE34R45-45	9.0M	45°	19.00KG

### 45° 2 WAYS CORNER

CODE GE34C19

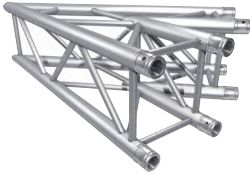

| 29 / 100 - 100

8.85KG

### 60° 2 WAYS CORNER

CODE GE34C20



| 29 / 100 - 100

9.97KG

### 90° 2 WAYS CORNER

CODE GE34C21



| 29 / 50 - 50

6.27KG

### 120° 2 WAYS CORNER

CODE GE34C22



| 29 / 50 - 50

6.48KG

### 135° 2 WAYS CORNER

CODE GE34C23



| 29 / 50 - 50

6.63KG

### 90° 3 WAYS CORNER

CODE GE34C30



| 50 / 50 - 50

8.98KG

### 3 WAYS T CORNER

CODE GE34T35



| 29 / 50 - 50

7.82KG

### 90° 4 WAYS CORNER

CODE GE34T40

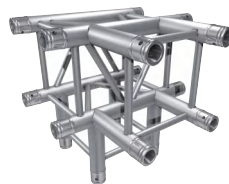

| 50 / 50 - 50

9.55KG

### 4 WAYS CROSS CORNER

CODE GE34T41

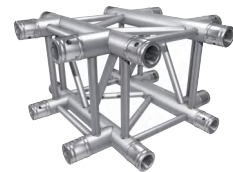

| 50 / 50 - 29

8.85KG

### 5 WAYS CORNER

CODE GE34C55



| 50 / 50 - 50

11.48KG

### BOX CORNER

CODE GE34BOX



| 29 / 29 - 29

5.69KG

### BASE PLATE

CODE GE34BASE

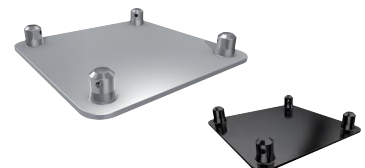

| 5 / 30 - 30

1.5KG



FLEXIBLE CORNER

CODE GE34FC0-180



| 29 / 8 - 34

9.9KG

SPINDLE

CODE GE34SD



| 35 / 29 - 29

2.5KG

BOX SPACER

CODE GE34BOXS105F  
CODE GE34BOXS210F



BOX HALF CONNECTOR

CODE GE34BOX-C



BASE HALF CONNECTOR

CODE 5003(ALUMINUM)  
CODE 5010(STEEL)



CONICAL CONNECTOR

CODE 5002

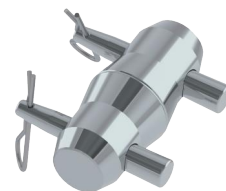

CONICAL HINGE

CODE 5029SR  
CODE 5029SL



PIN

CODE 5004PIN



R CLIP

CODE 5004CLIP

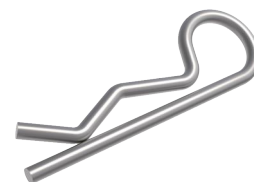

PIN & BOLT

CODE 5005



SPACER MALE

CODE 5019M105  
CODE 5020M170  
CODE 5021M210



SPACER FEMALE

CODE 5019F105  
CODE 5020F170  
CODE 5021F210

