

GE300B SQUARE

CODE	LENGTH	WEIGHT
GE300B050	50CM	7.74KG
GE300B100	100CM	10.84KG
GE300B150	150CM	14.00KG
GE300B200	200CM	17.12KG
GE300B250	250CM	20.25KG
GE300B300	300CM	23.38KG

SECTION

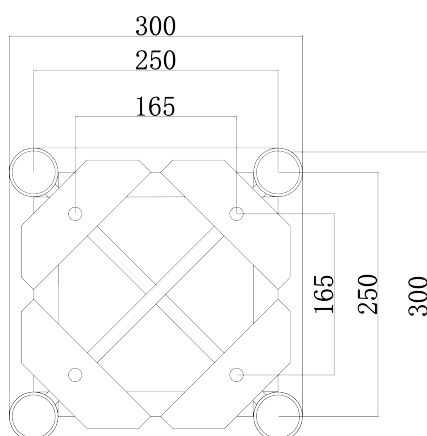

TECHNICAL DATA

Pipe Diameter	50mm
Wall Thickness	3.0mm
Brace	20 x2mm
Material	EN AW 6082 T6
Connectors	Included

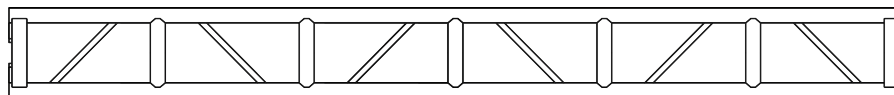
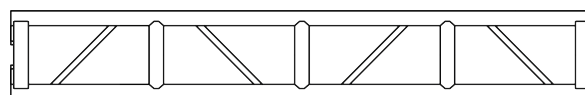
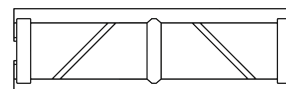

LOAD TABLE

Span	UDL	Deflection	CPL	Deflection	Point load in third-point	Deflection	Point load in quarter-point	Deflection
长度	承重量/m	弯曲度	中间点承重量	弯曲度	两点承重量	弯曲度	三点承重量	弯曲度
m	kg m	cm	kg	cm	kg	cm	kg	cm
2	1790	0.11	1790	0.09	1342	0.115	895.1	0.11
4	441.7	0.47	883.5	0.37	662.6	0.483	441.7	0.45
6	192	1.06	576.2	0.85	432.1	1.081	288.1	1
8	104.6	1.89	418.6	1.53	313.9	1.921	209.3	1.8
10	64.26	2.96	321	2.43	240.7	3.013	160.5	2.83
12	42.21	4.28	253.4	3.57	190	4.357	126.7	4.1
13	34.86	4.22	226.4	4.23	169.8	5.134	113.2	4.84
14	28.98	5.86	202.8	4.96	152.1	5.964	101.4	5.63
15	24.25	6.75	181.9	5.75	136.3	6.867	90.93	6.51
16	20.37	7.71	163	6.62	122.3	7.833	81.58	7.44



GE300B SQUARE

GE300B Bolt truss is adapted for conference, exhibition, and small venue work.

The truss consists of 50x3mm for the main chords and 25x2mm for diagonals. The trussing segments are connected by bolting triangle plates together.

GE300B 系列桁架为四方架系统，其材料均为通过 EN 认证的 6082 T6 铝合金型材，主管直径为 50mm，管壁厚度 3mm，副管直径 20mm，管壁厚度 2mm。此桁架为螺丝连接方式，属于多用途展示桁架，承载能力强，适用于文艺活动，展览会等场所。桁架的设计生产遵循德国工业标准，是一款极具性价比的优势产品。桁架可依照需求进行特殊造型定制，以及表面可做烤漆处理。